

EN

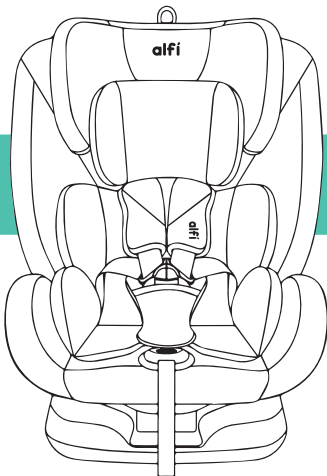

alfi.

(Group 0+ I II III)

• Fit Weight: 0 - 36 kg • Fit Age: 0 - 12 years old

Product Instruction

FIJI-7

GROUP: 0+, I, II, III (about Birth to 12 years old)



DEAR CUSTOMER

We wanted to take a moment to express our sincere gratitude for choosing Alfi carseat. We truly appreciate your trust and confidence in our brand, and given us the opportunity to have our Alfi children safety carseat to accomodate and protect your child in their daily commute.

We look forward to serving you in the future and continuing to provide you with exceptional products and customer service. Thank you once again for choosing Alfi carseat, we are delighted to have you as a valued customer.

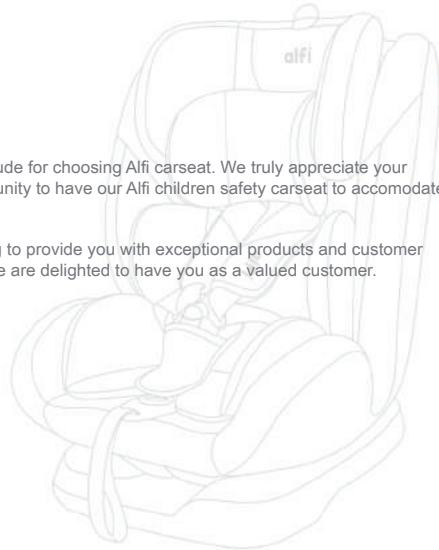

CONTENTS

1. Important Information	1-3
2. Vehicle Installation Tips	4-6
3. Pre-Installation and Function Introduction	7-11
3.1 ISOFIX Preparation	
3.2 Adjust the Shoulder Strap and Head Against the Child When Using a Harness	
3.3 Adjust the Head in the Case of a Child Using a Three-Point Vehicle Seat Belt	
3.4 Tilt Adjustment and 360 Degree Rotation Adjustment of Children's Safety Seats	
4. Rear-Facing Installation Instructions	12-17
4.1 Group 0+ (0-13kg)	
ISOFIX + Top Tether + Harness	
5. Forward Installation Instructions	18-27
5.1 Group I (9-18kg)	
Three-Point Car Seat Belts + Harness	
5.2 Group II (15-25kg), Group III (22-36kg)	
Three-Point Car Seat Belts	
5.3 Group II (15-25kg), Group III (22-36kg)	
ISOFIX+Three-Point Car Seat Belts	
6. Disassembly of ISOFIX Connectors	28
7. Hide Harness	29
8. Cloth Cover Cleaning	30

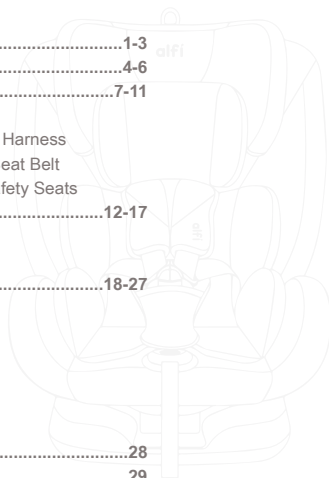

1

NOTICE

Please read the instructions carefully, because improper installation may cause serious injury, in this case, the manufacturer is not responsible.

Use range

This child safety seats are suitable for children from birth to 36 kg (ie 0 +, I, II, III, from birth to about 12 years of age.)

FIJI-7

Group 0+	0-13KG	ISOFIX + Top Tether + harness (rear-facing installation)
Group I	9-18KG	Three-point car seat belts + harness (forward installation)
Group I	9-18KG	ISOFIX + Three-point car seat belts + harness (forward installation)
Group II, III	15-36KG	Three-point car seat belts (forward installation)
Group II, III	15-36KG	ISOFIX + Three-point car seat belts (forward installation)

Warning

- ! **Important** - Do not use forward facing before the child's weight exceeds 9 kg.
- ! **Important** - Please read all instructions in this manual and in the vehicle owner's manual related to child safety seats carefully and understand them. Install and use the child safety seat as described in the instruction manual. Failure to do this could result in serious injury or death of your child. Keep the instruction manual with the child safety seat for future use.
- ! **Important!** Because of potential medical issues inherent in low birth weight and premature infants, always have a trained professional, doctor, or hospital staff member assess the suitability of the child restraint prior to leaving the hospital or using the child restraint.
- ! DO NOT try to remove and labels on the child safety seat. Important information is contained on the labels.
- ! DO NOT modify or attempt to modify the child safety seat in any way.
- ! DO NOT take apart or attempt to take apart the child safety seat except as instructed in this manual.
- ! DO NOT use the child safety seat with damaged or missing parts.
- ! DO NOT use damaged or frayed harness straps or vehicle belt.
- ! NEVER use this child safety seat without the car seat cover.
- ! DO NOT replace the child seat cover or harness with any other than the ones we recommend as these parts are integral to the child safety seat's performance.
- ! DO NOT use a child safety seat that has been in a crash. A crash can cause damage to the child safety seat that you cannot see.
- ! DO NOT use a second-hand child seat or child seat whose history you do not know.
- ! ALWAYS check the tightness of the restraint and the harness before each use.
- ! ALWAYS make sure all vehicle belts and harness straps are not twisted before each use.
- ! NEVER leave the child in the child seat when the harness straps are loose or undone.
- ! NEVER leave your child unattended even for a short time.
- ! DO NOT leave your child in this restraint for an extended period of time.
- ! DO NOT use on the vehicle seats that face the sides or rear of the vehicle. Use the child safety seat only on the vehicle seats that face forward.
According to accident statistics, children are safer when properly restrained in the rear seating positions than in the front seating position.
- ! Make sure any straps holding the restraint to the vehicle should be tight, that any straps restraining the child should be adjusted to the child's body, and that straps not be twisted.
- ! Make sure any lap strap is worn low down, so that the pelvis is firmly engaged, shall be stressed.



Products that are not approved for certification and modified products are dangerous and the installation instructions provided by the manufacturer without the manufacturer are also dangerous.

If the adult seat belt relative to the child restraint system of the main force point position mutual interference, can not be used. If you have any questions about this point, please contact the child restraint system manufacturer.

① UNIVERSAL: Group I (9-18kg)

Three - point car seat belt + harness

② UNIVERSAL: Group II (15-25kg) Group III (22-36kg)

Three-point car seat belts



This is a "Universal" child restraint. It is approved to Regulation NO 44,04 series of amendments, for general use in vehicles and it will fit most, but not all, car seats.

A correct fit is likely if the vehicle manufacturer has declared in the vehicle handbook that the vehicle is capable of accepting a "Universal" child restraint for this age group.

This child restraint has been classified as "Universal" under more stringent conditions than those which applied to earlier designs which do not carry this notice.

If in doubt, consult either the child restraint manufacturer or the retailer.

Only suitable if the approved vehicles are fitted with 3 point with retractor safety-belts, approved to UN/ECE Regulation No. 16 or other equivalent standards.

③ ISOFIX SEMI-UNIVERSAL: 0+ group (0-13kg)

Three-point car seat belts + harness



1. This is an ISOFIX CHILD RESTRAINT SYSTEM. It is approved to Regulation No.44,04 series of amendments for general use in vehicles fitted with ISOFIX anchorages systems

2. It will fit vehicles with positions approved as ISOFIX positions (as detailed in the vehicle handbook), depending on the category of the child seat and of the fixture

3. The mass group and the ISOFIX size class for which this device is intended is: D, GROUP 0+ Less than 13KG.

This Child Restraint is classified for Semi-universal use and is suitable for fixing into the seat positions of the following cars:

CAR	FRONT SEAT	REAR SEAT	
	Outer	Outer	Centre
VEHICLE LIST	No	Yes	No

Seat positions in other cars may also be suitable to accept this child restraint. If in doubt, consult either the child restraint manufacturer or the retailer.

④ SEMI-UNIVERSAL: Group II (15-25kg), Group III (22-36kg)

ISOFIX + three-point car seat belts



This Child Restraint is classified for Semi-universal use and is suitable for fixing into the seat positions of the following cars:

CAR	FRONT SEAT	REAR SEAT	
	Outer	Outer	Centre
VEHICLE LIST	No	Yes	No

Seat positions in other cars may also be suitable to accept this child restraint. If in doubt, consult either the child restraint manufacturer or the retailer.

2

Vehicle Installation Tips



2.1 Rear-facing installation tips

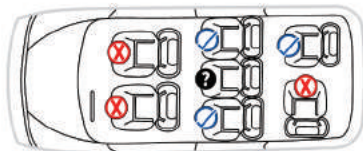

DANGER! When a child is installed in a reverse installation of a seat, if hit by a car airbag, it will cause fatal injury which may result in death.

! In any case, the child's safety seat can not be used in the car seat where the airbag has been activated.

Please read the instructions carefully so that you can use the child safety seat correctly

- Correct device / suitable
- Wrong device / unsuitable
- If the seat with ISOFIX anchorages and top tether anchorages is applicable.

2.2 Forward installation tips



① car seat belts - shoulder belt

② car seat belts - lap belt



You can not use this seat on a seat with only two-point seat belts

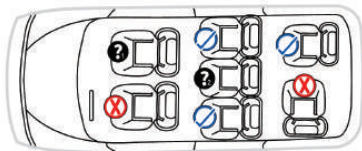

Correct device /suitable



Wrong device / unsuitable

This section of the child's safety seat is equipped with a seat belt with a 3-point belt conveyor with the requirements of GB27887 or ECER16. It is not suitable for models with only 2-point seat belts.



If the seat in front of an airbag, you can not install in this position.



Only equipped with a three-point seat belt, can do this location to install.

3

Pre-Installation and Function Introduction



3.1 ISOFIX preparation

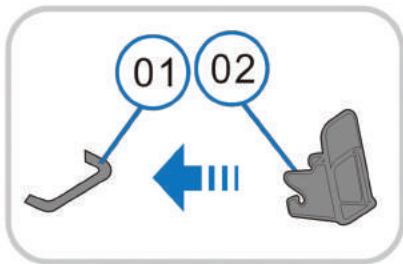

(Fig3.1.1)

3.1.1 If your vehicle is not equipped with an ISOFIX guide sleeve, insert the two ISOFIX guides (02) that come with the child's safety seat into the ISOFIX fixture (01) (Fig 3.1.1)

Tip: The ISOFIX fixture is located between the seat of the vehicle and the backrest.

Please read the instructions in the car manufacturer's manual for ISOFIX fixed points.

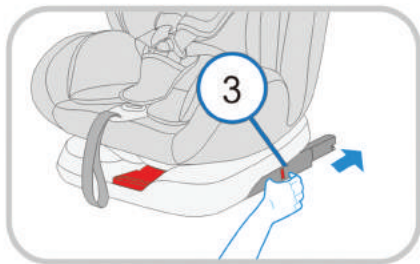

(Fig3.1.2)

3.1.2 Press ISOFIX release key (03) and push ISOFIX forward to release it to the furthest. (Fig 3.1.2)

3.2 Adjust the shoulder strap and head against the child when using a harness (Group 0 +, I)

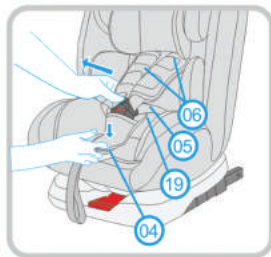

(Fig 3.2.1)

3.2.1 Press the central adjuster (04) to pull out both straps (05) at the same time. Please do not pull the shoulder pad (06) to release the harness to the longer position. (Fig 3.2.1)

Tip: Shoulder outlet can no longer be below the shoulder of the child or above the height of the ear.



(Fig 3.2.2)

3.2.2 Pull up or down to press the adjustment ring (07), so that the head (08) is adjusted to the appropriate position of the child and is fixed. (Fig 3.2.2)

3.3 Adjust the head in the case of a child using a three-point vehicle seat belt (Group II, III)



(Fig 3.2.1)

3.3.1 Pull up the adjustment ring (07) to adjust the head to the appropriate position of the child and fix it. (Fig 3.2.1)



(Fig 3.2.2)

3.3.2 The correct adjustment of the safety seat head (08) is to ensure that the car seat belt diagonal part (09) is in the best position, which can provide the best protection for children. The safety seat head (08) must be adjusted to bring about two fingers between the child's shoulder and the safety seat head (08). (Fig 3.3.2)

3.4 Tilt adjustment and 360 degree rotation adjustment of children's safety seats



(Fig 3.4.1)

3.4.1 Press adjusting handle according to the direction of arrow (10), keep seat unlocked, then seat can incline to an appropriate position (11), release adjusting handle (10), seat locks itself again. (Fig 3.4.1) (Fig 3.4.2)



(Fig 3.4.2)



(Fig 3.4.3)

3.4.2 Press adjusting handle according to the direction of arrow (32) to unlock seat (11), rotate seat (11) to an appropriate position, release adjusting handle (32), seat locks itself. (Fig 3.4.3)

4

Rear-Facing Installation Instructions



4.1 Group 0 + (0-13kg) children ISOFIX + Top Tether + Harness



(fig4.1.1)

- 4.1.1 Please arrange ISOFIX according to Sector 3.1
- 4.1.2 Please ensure that five points safety belt is installed correctly at child safety seat. (refer to Sector 3.2)
- 4.1.3 Please adjust five points safety belt according to Sector 3.2.
- 4.1.4 Adjust seat to the uttermost inclined position and fix it according to Sector 3.4 (don't slide or rotate it).
- 4.1.5 Confirm whether seat is at an inclined position, on the seat targets at gear 5 at bottom seat. Then install child safety seat at the opposite direction to the driving direction of car. (refer to Fig 4.1.1)

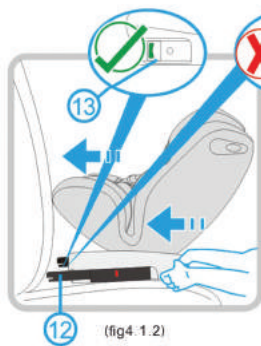

(fig 4.1.2)

4.1.6 Please insert two ISOFIX connectors (12) to ISOFIX guide sleeves (02) until tick is made. At the moment, ISOFIX indicator turns green (13). (Fig 4.1.1) (Fig 4.1.2)

Note: ISOFIX connector (12) is installed correctly only if the ISOFIX indicator (13) is completely green.

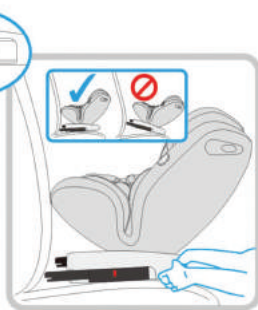

(fig 4.1.3)

4.1.7 Push safety seat with full force until it reaches the backrest of car seat. (Fig 4.1.3)



(fig 4.1.4)

4.1.8 Press and pull the button of regulator up, release top tether to an appropriate length. (Fig 4.1.4)

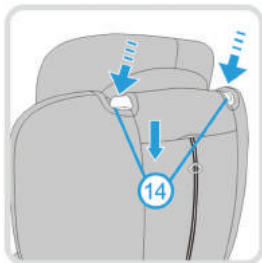

(Fig 4.1.5)



(Fig 4.1.6)



(Fig 4.1.7)

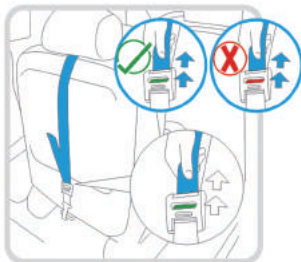

(Fig 4.1.8)

4.1.9 Put the top tether in one of guide grooves (14) on shoulder (Fig 4.1.5) (Fig 4.1.6)

4.1.10 Pull free end of the top tether until the indicator of regulator of top tether turns green. (Fig 4.1.8)

4.1.11 Hang the top tether at the fixed point recommended in user manual. (Fig 4.1.7)

4.1.12 Install child seat according to the steps for five points safety belt used by children.

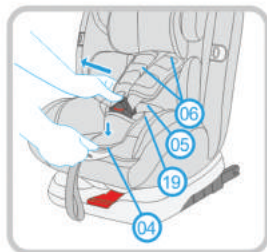

(fig 4.1.9)

4.1.13 Use of five points safety belt. Press red button to open five points safety pin (19). Press central regulator (04) and pull shoulder girdle out. Don't pull shoulder pad (06). (Fig 4.1.9)

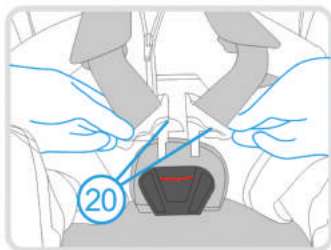

(fig 4.1.10)

Please ensure child's back rests on safety seat. Close two lock of five points safety pin (20), then lock it. Tick will be heard after correct locking. (Fig 4.1.10) (Fig 4.1.11) (Fig 4.1.12)

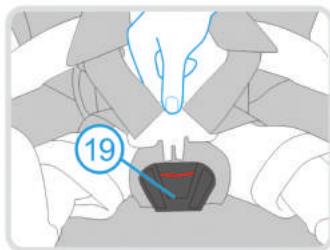

(fig 4.1.11)

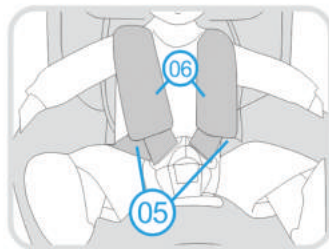

(fig 4.1.12)

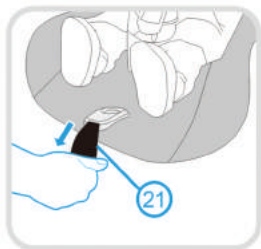

(fig 4.1.13)



(fig 4.1.14)

Pull central regulating belt(21) until five points safety belt approaches child.
(Fig 4.1.13) (Fig 4.1.14)

In order to guarantee the safety of child, please check the following items after each installation:

- 1.Ensure that two ISOFIX connectors are connected to ISOFIX fixed points of car and the indicator of ISOFIX turns green.**
- 2.Ensure that child safety seat sticks to car seat.**
- 3.Ensure that top tether is closely tied up and the indicator of top tether is green.**
- 4.Ensure that five points safety belt sticks to child but doesn't press child.**
- 5.Ensure that the adjustment of shoulder girdle is correct and not twisted.**
- 6.Ensure the height of shoulder pad is same as that of child's shoulder.**
- 7.Ensure five points buckle is locked.**

5

Forward Installation Instructions



5.1 Group I (9-18kg) children Three-Point Car Seat Belts + Harness



(fig 5.1.1)

5.1.1 Please ensure five points safety belt is installed on child safety seat correctly. (refer to Sector 3.2).

5.1.2 Please adjust five points safety belt according to Sector 3.2.

5.1.3 Please adjust seat (11) to an appropriate position according to Sector 3.4 and confirm its is locked (can't slide).

5.1.4 Please adjust seat (11) to the forward position and confirm it is locked (can't rotate).

5.1.5 Please put child safety seat at car seat with the same direction as the driving direction of car. (Fig 5.1.1).

5.1.6 Adjust child safety seat to Gear 1 or 5. The seat has five gears. Gear 1 is upright position. Gear 5 is oblique position. (Fig 5.1.3)(Fig 5.1.4)

5.1.7 Please pull out three points safety belt of car, slide abdominal belt into two guiding belt hooks of foundation (23), insert plug of car belt into buckle and tighten car belt. (Fig 5.1.2)



(fig 5.1.2)



(fig 5.1.3)



(fig 5.1.4)



(fig 5.1.5)



(fig 5.1.6)



(fig 5.1.7)

5.1.8 Three points car belts 1 and 2 are located behind bed roll and between backrest of child seat and bed roll. (Fig 5.1.5) (Fig 5.1.6)

5.1.9 Tighten car belt and ensure car belt is not loose. (Fig 5.1.7)

5.1.10 Please install child seat according to the steps that child uses five points safety belt in 4.1.14.

In order to guarantee the safety of child, please check the following items after each installation:

- 1. Ensure that car belt is not twisted or loose.**
- 2. Ensure that child safety seat sticks to car seat.**
- 3. Ensure that five points safety belt sticks to child but doesn't press child.**
- 4. Ensure that the adjustment of shoulder girdle is correct and not twisted.**
- 5. Ensure the height of shoulder pad is same as that of child's shoulder.**
- 6. Ensure five points buckle is locked.**

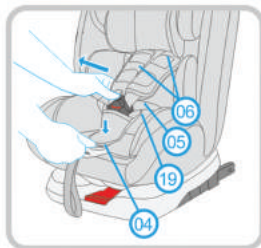

(fig 5.1.8)

5.1.11 Use of five points safety belt. Press red button to open five points safety pin (19). Press central regulator (04) and pull shoulder girdle out (05). Don't pull shoulder pad (06). (Fig 5.1.8)

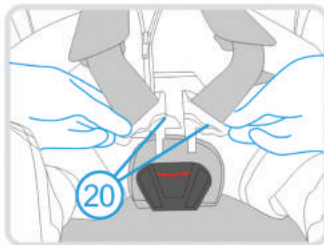

(fig 5.1.9)

Please ensure child's back rests on safety seat. Close two lock of five points safety pin (20), then lock it. Tick will be heard after correct locking. (Fig 5.1.9) (Fig 5.1.10) (Fig 5.1.11)

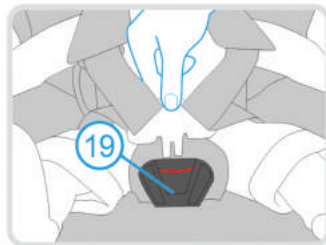

(fig 5.1.10)

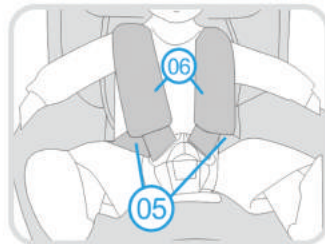

(fig 5.1.11)

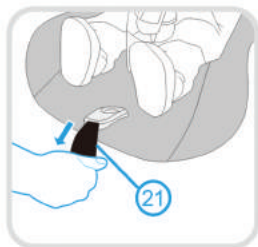

(fig 5.1.12)



(fig 5.1.13)

Pull central regulating belt (21) until five points safety belt approaches child.
(Fig 5.1.12)(Fig 5.1.13)

In order to guarantee the safety of child, please check the following items after each installation:

- 1. Ensure that two ISOFIX connectors are connected to ISOFIX fixed points of car and the indicator of ISOFIX turns green.**
- 2. Ensure that child safety seat sticks to car seat.**
- 3. Ensure that top tether is closely tied up and the indicator of top tether is green.**
- 4. Ensure that five points safety belt sticks to child but doesn't press child.**
- 5. Ensure that the adjustment of shoulder girdle is correct and not twisted.**
- 6. Ensure the height of shoulder pad is same as that of child's shoulder.**
- 7. Ensure five points buckle is locked.**

5.2 Group II (15-25kg), Group III (22-36kg) children

Three-Point Car Seat Belts

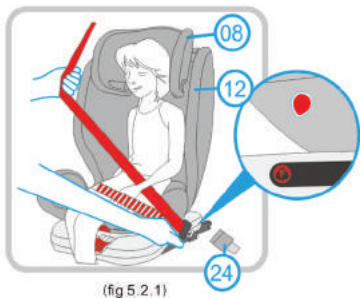

(fig 5.2.1)



(fig 5.2.2)

- 5.2.1 Please ensure the five points safety belt of safety seat is hidden correctly. (refer to Sector 7)
 - 5.2.2 Please ensure adjust headrest according to Sector 3.3 (08).
 - 5.2.3 Please adjust seat (12) according to Sector 3.4 and confirm it is locked (can't slide or rotate).
 - 5.2.4 Put child safety seat on car seat at the same direction as the driving direction of car and seat child in safety seat.
 - 5.2.5 Please adjust child safety seat to Gear 1. The seat has five gears. And Gear 1 is upright position.
 - 5.2.6 Pull safety belt out, tie child with it and insert the spile of car belt into buckle (24). Tick will be made in normal situation (Fig 5.2.1)
- Warning: ensure car belt is not twisted**
- 5.2.7 Insert waist belt (25) and abdominal belt (26) near the buckle of car belt (24) into guiding belt groove (27) below child's arms (Fig 5.2.2).

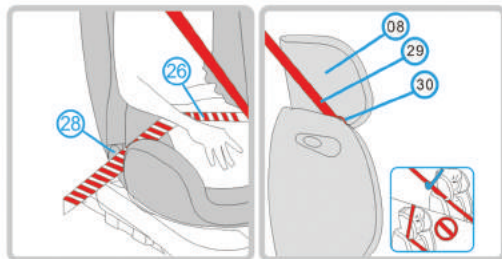

(fig 5.2.3)

(fig 5.2.4)

5.2.8 Insert the other side of abdominal belt of car belt (26) into the guiding belt groove on the other side (28). (Fig 5.2.3)

5.2.9 Put the upper part of shoulder girdle of car belt (29) into the groove of guiding belt hook (30) on headrest (08) and ensure car belt is not twisted. (Fig 5.2.4)

5.2.10 Please ensure the upper part of waist belt of car belt (29) is above clavicle of child rather than neck.
Prompt: you still can adjust head rest if necessary.

In order to ensure the safety of child, please check the following items after each installation:

- 1. Ensure waist belt (24) and abdominal belt (26) near car belt buckle (24) are in guiding belt groove (27).**
- 2. Ensure the other side of car safety belt is in the guiding belt groove on the other side (28).**
- 3. Ensure the upper part of shoulder girdle of car belt (29) is in the groove of belt hook (30) on headrest (08).**
- 4. Ensure the upper part of shoulder girdle of car belt (29) is above child's clavicle rather than his neck.**
- 5. Ensure car belt is not twisted and is tight.**

5.3 Group II (15-25kg), Group III (22-36kg) children

ISOFIX+Three-Point Car Seat Belts

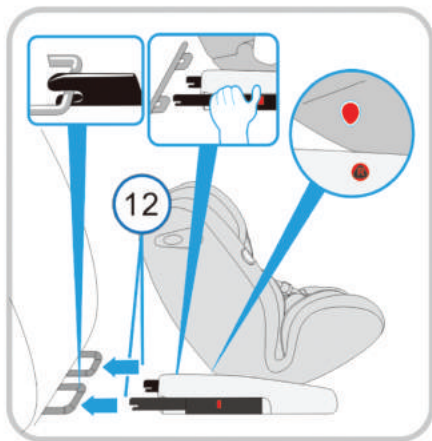

(fig 5.3.1)

5.3.1 Please ensure the five points safety belt of safety seat is hidden correctly. (refer to Sector 7)

5.3.2 Please arrange ISOFIX according to Sector 3.1.

5.3.3 Please adjust seat (11) according to Sector 3.4 and confirm it is locked (can't slide or rotate).

5.3.4 Put child safety seat on car seat at the same direction as the driving direction of car and seat child in safety seat.

5.3.5 Please adjust child safety seat to Gear 1. The seat has five gears. And Gear 1 is upright position. (Fig 5.3.1)

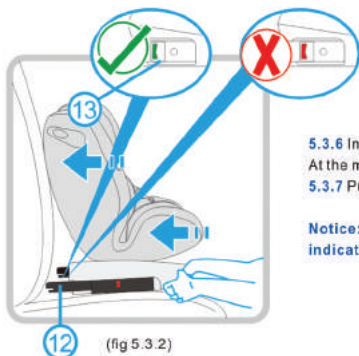

- 5.3.6 Insert two ISOFIX connector (12) into ISOFIX guiding sleeve (02) until tick is heard. At the moment, ISOFIX indicator (13) turns green. (Fig 5.3.1) (Fig 5.3.20)
- 5.3.7 Push safety belt until it sticks to the backrest of car seat. (Fig 5.3.3)

Notice: ISOFIX connector (12) is considered installed correctly only when ISOFIX indicator (13) turns green.



In order to ensure the safety of your child, please check the following items after each installation:

1. Ensure that two ISOFIX connectors are connected to ISOFIX fixed points of car and the indicator of ISOFIX turns green.
2. Ensure that child safety seat sticks to car seat.
3. Ensure that top tether is closely tied up and the indicator of top tether is green.
4. Ensure that five points safety belt sticks to child but doesn't press child.
5. Ensure that the adjustment of shoulder girdle is correct and not twisted.
6. Ensure the height of shoulder pad is same as that of child's shoulder.
7. Ensure five points buckle is locked.
8. Please seat is at Gear 1.

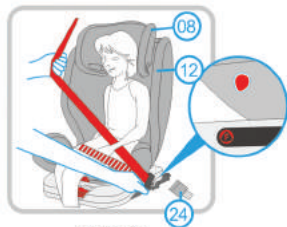

(fig 5.3.4)



(fig 5.3.5)



(fig 5.3.6)

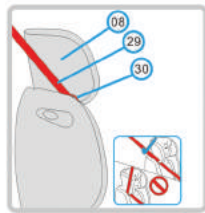

(fig 5.3.7)

5.3.8 Please adjust headrest according to Sector 3.3 (08).

5.3.9 Pull safety belt out, tie child with it and insert the spile of car belt into buckle (24). Tick will be made in normal situation (Fig 5.3.4)

Warning: ensure car belt is not twisted

5.3.10 Insert waist belt (25) and abdominal belt (26) near the buckle of car belt (24) into guiding belt groove (27) below child's arms (Fig 5.3.5).

5.3.11 Insert the other side of abdominal belt of car belt (26) into the guiding belt groove on the other side (28). (Fig 5.3.6)

5.3.12 Put the upper part of shoulder girdle of car belt (29) into the groove of guiding belt hook (30) on headrest (08) and ensure car belt is not twisted. (Fig 5.3.7)

5.2.13 Please ensure the upper part of waist belt of car belt (29) is above clavicle of child rather than neck.

Notes: you still can adjust headrest if necessary.

- 1.Ensure waist belt (24) and abdominal belt (26) near car belt buckle (24) are in guiding belt groove (27).
- 2.Ensure the other side of car safety belt is in the guiding belt groove on the other side (28).
- 3.Ensure the upper part of shoulder girdle of car belt (29) is in the groove of belt hook (30) on headrest (08).
- 4.Ensure the upper part of shoulder girdle of car belt (29) is above child's clavicle rather than his neck.
- 5.Ensure car belt is not twisted and is tight.

6

Disassembly of ISOFIX Connectors

Disassemble as Fig 6.1 Shown: Press the ISOFIX release button, when the button shows red. It's released.

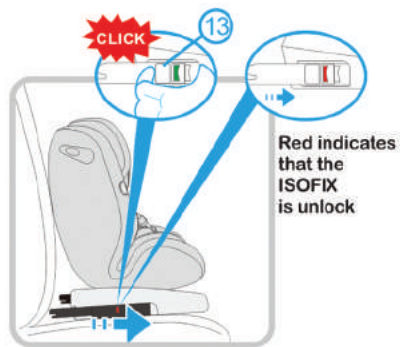

(Fig 6.1)

7

Hide Harness



(fig 7.1)



(fig 7.2)



(fig 7.3)



(fig 7.4)



(fig 7.5)



(fig 7.6)



(fig 7.7)

7.1 Release five points belt. (Fig 7.1)

7.2 Flip open the back pad. (Fig 7.2)

7.3 Press central regulating key and stretch five points safety belt. (Fig 7.3) (Fig 7.4)

7.4 Hide shoulder pad behind the cloth sleeve (Fig 7.4) (Fig 7.5) (Fig 7.6)

7.5 Put buckle in the hole of seat buckle (Fig 7.7)

8

Cloth Cover Cleaning



(fig 8.1)

Dismantle cloth sleeve:

8.1 Adjust headrest to the highest position. (Fig 8.1)

8.2 Take down cloth sleeve.

8.3 Take down cloth sleeve of seat.

HAND WASH ONLY

Use Mild Detergent

Do not Iron, Dry Clean, Bleach or Tumble Dry

Dry flat-away from Direct heat

**DO NOT USE BLEACH, ABRASIVE
OR UPHOLSTERY CLEANING AGENTS**



9

Applicable Vehicle List



9.1 List of vehicles used

As a semi-universal child safety seat, it will fit in the seat position of the following vehicle list:

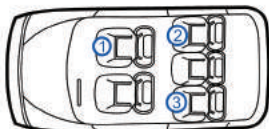

Vehicle manufacturer	Vehicle model	ISOFIX			Three-point vehicle safety belt		
		1	2	3	1	2	3
Ford	B Max(2012>)	○	●	●	○	●	●
	Fiesta(2008>)	○	●	●	○	●	●
	Focus(2010>)	○	●	●	○	●	●
	KA(2009>)	○	●	●	○	●	●
	Kuga(2013>)	○	●	●	○	●	●
Nissan	Juke(2010>)	○	●	●	○	●	●
	X-Trail(2007>)	○	●	●	○	●	●
Volvo	C30(2007–2012)	○	●	●	○	●	●
	S80(2007>)	○	●	●	○	●	●
	V40(2012>)	○	●	●	○	●	●
	V60(2011>)	○	●	●	○	●	●
	V70(2008>)	○	●	●	○	●	●
	XC70(2008>)	○	●	●	○	●	●

Vehicle manufacturer	Vehicle model	ISOFIX			Three-point vehicle safety belt		
		1	2	3	1	2	3
Alfa Romeo	Gulietta(2010>)	○	○	○	○	●	●
	Mito(2009>)	○	●	●	○	●	●
Audi	A1(2011>)	○	●	●	○	●	●
	A1 Sportback(2012>)	○	●	●	○	●	●
	A4 Allroad(2009>)	○	●	●	○	●	●
	A4 Av ant(2008>)	○	●	●	○	●	●
	A4 S4(2009>)	○	●	●	○	●	●
	A54(2007>)	○	●	●	○	●	●
	A5 Sportback(2009>)	○	●	●	○	●	●
	A6(2011>)	○	●	●	○	●	●
	A6 Allroad(2011>)	○	●	●	○	●	●
	A6 Avant(2011>)	○	●	●	○	●	●
	A6 S6(2011>)	○	●	●	○	●	●
	A7 Sportback(2011>)	○	●	●	○	●	●
	A8(2011>)	○	●	●	○	●	●
	A8 S8(2011>)	○	●	●	○	●	●
	Q3(2013>)	○	●	●	○	●	●
Q5(2009>)	○	●	●	○	●	●	
Q7(2006>)	○	●	●	○	●	●	
Bentley	Continental GT(2003–2011)	○	●	●	○	●	●
	Continental GTC(2005–2012)	○	●	●	○	●	●
	Mulsanne(2010>)	○	●	●	○	●	●

9.1 List of vehicles used

Vehicle manufacturer	Vehicle model	ISOFIX			Three-point vehicle safety belt		
		1	2	3	1	2	3
BMW							
	1 Series Convertible(2008>)	○	●	●	○	●	●
	1 Series Coupe(2008>)	○	●	●	○	●	●
	3 Series Coupe(2007>)						
	5 Series(2011>)	○	●	●	○	●	●
	6 Series Coupe(2011>)	○	●	●	○	●	●
	7 Series(2010>)	○	●	●	○	●	●
	X3 F25(2011>)	○	●	●	○	●	●
	X5(2007>)	○	●	●	○	●	●
	X6(2008>)	○	●	●	○	●	●
	5-GT(2010>)	○	●	●	○	●	●
Cadillac		○	●	●	○	●	●
	BLS Saloon(2006-2011)	○	●	●	○	●	●
Chevrolet		○	●	●	○	●	●
	Aveo 3dr(2012>)	○	●	●	○	●	●
	Aveo 5dr(2012>)	○	●	●	○	●	●
	Captiva(2007>)	○	●	●	○	●	●
	Cruze(2009>)	○	●	●	○	●	●
	Spark(2009>)	○	●	●	○	●	●
	Volt(2008>)	○	●	●	○	●	●
	A4 54(2011>)	○	●	●	○	●	●
Chrysler							
	Grand Voyager(2008>)	○	●	●	○	●	●
	Ypsilon(2011>)	○	●	●	○	●	●
	300C(2012>)	○	●	●	○	●	●





alfi[®]